

ADDING TRIM STRIP TO WIND DEFLECTOR ON REPLACEMENT CANOPY OF OMEGA AWNINGS

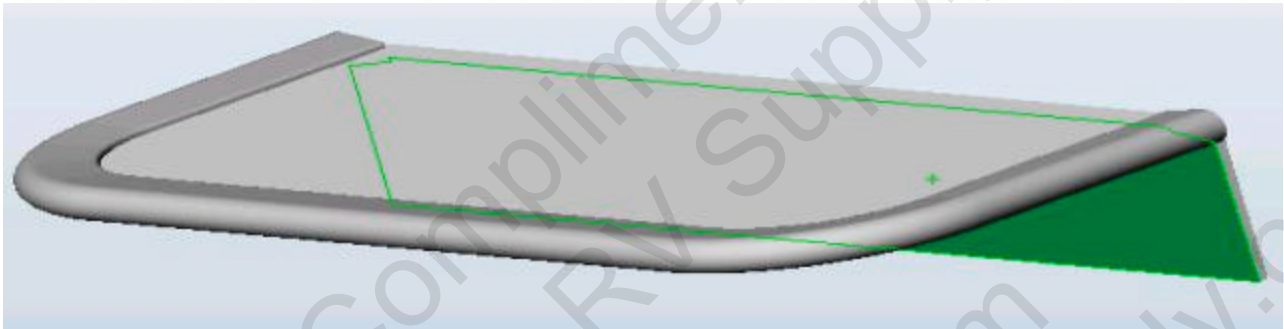

If replacing the canopy on an Omega awning that utilizes a wind deflector, install the supplied trim strip along the edge of the wind deflector as show. This will prevent the fabric from tearing as it overlaps the sharp edge of the deflector.

This Manual is Compliments of

Northwest RV Supply

86325 College View Road
Eugene, OR 97405

Local: 541-746-9092

Toll-Free: 866-678-7467

Fax: 541-736-5573

<http://www.nwrvsupply.com>
mail@nwrvsupply.com

Northwest RV Supply carries a large spectrum of surplus, used, and new RV parts and components. Please feel free to visit our website for additional information.